

# Introducing an important step-change in how House Builders and Developers balance creativity and cost control.

The soon-to-be launched *House Builder Pack 360* from HBXL is a unique end-to-end solution for house-building. It is set to transform the process of designing houses from days to minutes. That's concept to fully costed working drawing (including 3D models), contracts and health & safety documents, ready to build using our project management platform. It's an indispensable software suite, driving faster, smarter design decisions and more profitable housing developments.

**Scaleability | Cost Control | Compliance | Collaboration | Profitability**

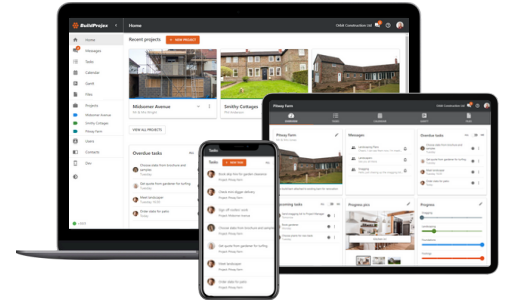
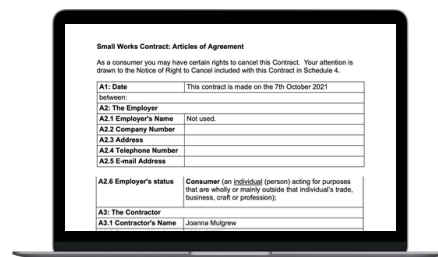
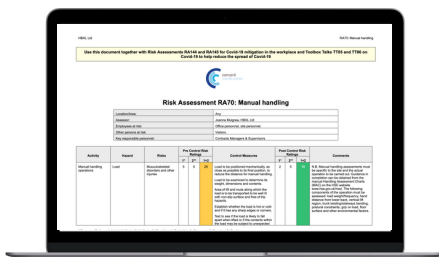
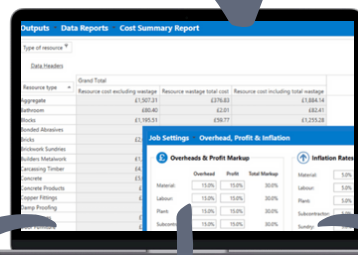
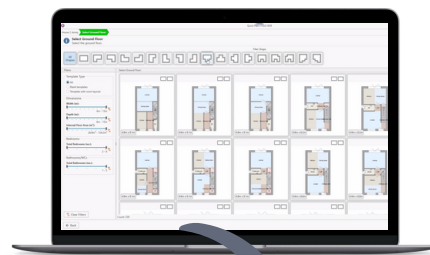

## Powering scalable delivery for house builders and developers

**Quick Plan** will redefine how developers design and deliver housing portfolios. This significant new module provides thousands of fully customisable design options, with hundreds of permutations that generate complete working drawings and photorealistic models in seconds. Developers can refine schemes until they balance design intent with financial viability - accelerating feasibility, value engineering, and portfolio decision-making.

Soon-to-be launched *Quick Plan* sits within *House Builder Pack 360*, HBXL's fully integrated software suite for developers. With six connected tools - *Quick Plan*, *PlansXpress*, *EstimatorXpress*, *Health & Safety Xpert*, *ContractsXpert*, and *BuildProjex* - the suite offers a unified workflow from feasibility to completion. Data remains consistent across projects, providing scalability and portfolio-level insight.

*House Builder Pack 360* ensures schemes are commercially viable from the outset. It's backed by 25 years of innovation and a £4M+ investment. HBXL is already the digital backbone of SME construction.

### 01

#### How HBXL supports House Builders & Developers

##### 1. Scalable, Data-Driven Design

- Infinite style options thanks to multiple design templates and permutations delivered in seconds.
- Instant working drawings and photorealistic models within *PlansXpress*.
- Enables rapid feasibility testing across multiple sites and portfolios.

##### 2. Cost Certainty & Risk Control

- *EstimatorXpress* provides cost breakdowns direct from designs.
- Covers labour, materials, plant, subcontractors, prelims, inflation, and contingencies.
- Portfolio-wide reporting supports accurate forecasting and financial governance.

##### 3. Compliance & Governance

- *Health & Safety Xpert* generates site-specific documentation automatically.
- *ContractsXpert* produces legally robust contracts and payment schedules.
- Ensures corporate governance standards are met across every project.

##### 4. Portfolio Oversight & Collaboration

- *BuildProjex* delivers cloud-based project tracking with milestones, and live updates.
- Provides central oversight across multiple developments.
- Enhances accountability and transparency for boards, investors, and external stakeholders.

### 02

#### The Strategic Opportunity

*House Builder Pack 360* offers corporate developers a practical, scalable solution for delivering housing portfolios efficiently, compliantly, and profitably. By uniting design innovation with rigorous cost and compliance management, it provides confidence from feasibility through to completion.

### 03

#### Be involved from the start - let's talk

Adopt the UK's fastest end-to-end digital platform for housing delivery | Accelerate portfolio feasibility and approvals | Strengthen governance and risk management | Improve cost forecasting and reporting

Email [adrian.wild@hbxl.co.uk](mailto:adrian.wild@hbxl.co.uk) | 0117 916 7898 | [www.hbxl.co.uk/proptech/](http://www.hbxl.co.uk/proptech/)